

1

Stage 1

Specs



TORONTO STUDIOS™

1 Specifications

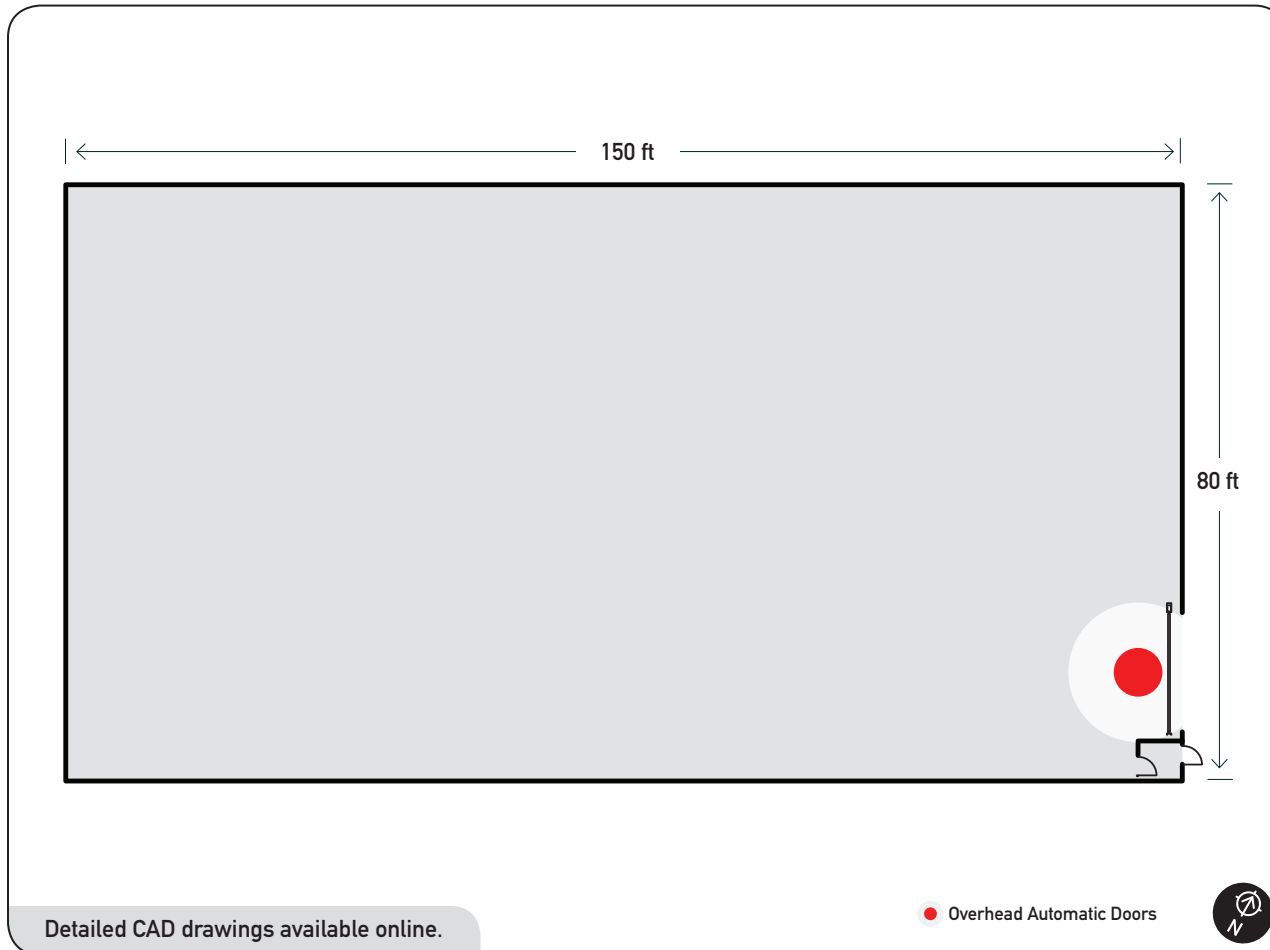

Stage Type	Soundstage, clear span
Area (sq ft)	12,000
Area (sq m)	1,115
Length (ft)	150
Length (m)	46
Width (ft)	80
Width (m)	24
Height to Grid (ft)	40
Height to Grid (m)	12
Power – 3 Phase (amps)	1,460
Dimmer Rooms	1
16'x16' Overhead Automatic Doors	1
Load Leveller	No
Beam Load (lbs per sq ft)	30
Floor Load (lbs per sq ft)	250
Heat Type	Gas
A/C	Yes

For more information visit pinewoodtorontostudios.com
or call us at 416 406-1235

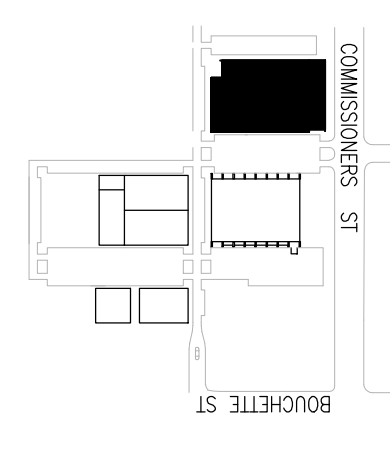
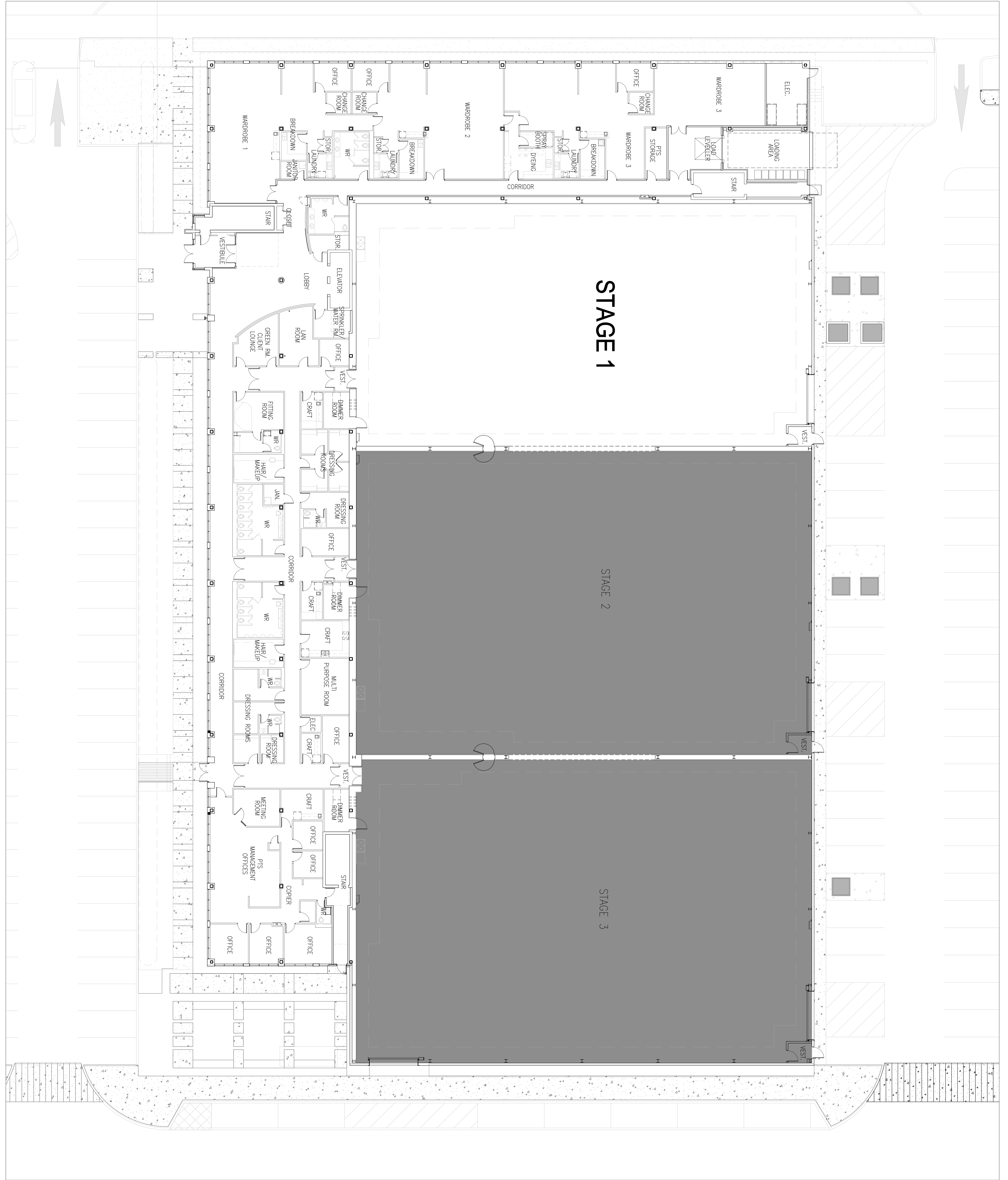

KEY PLAN
 STAGE 1
 STAGE 2
 STAGE 3



225 Commissioners Street
 Toronto, Ontario
 416 406-1235

1:125

Block 2: Stages 1 - 3
 Ground Floor Plan

BK2-A201

