

STAGE 10 | EXISTING GROUND FLOOR LAYOUT

PINEWOOD TORONTO STUDIOS

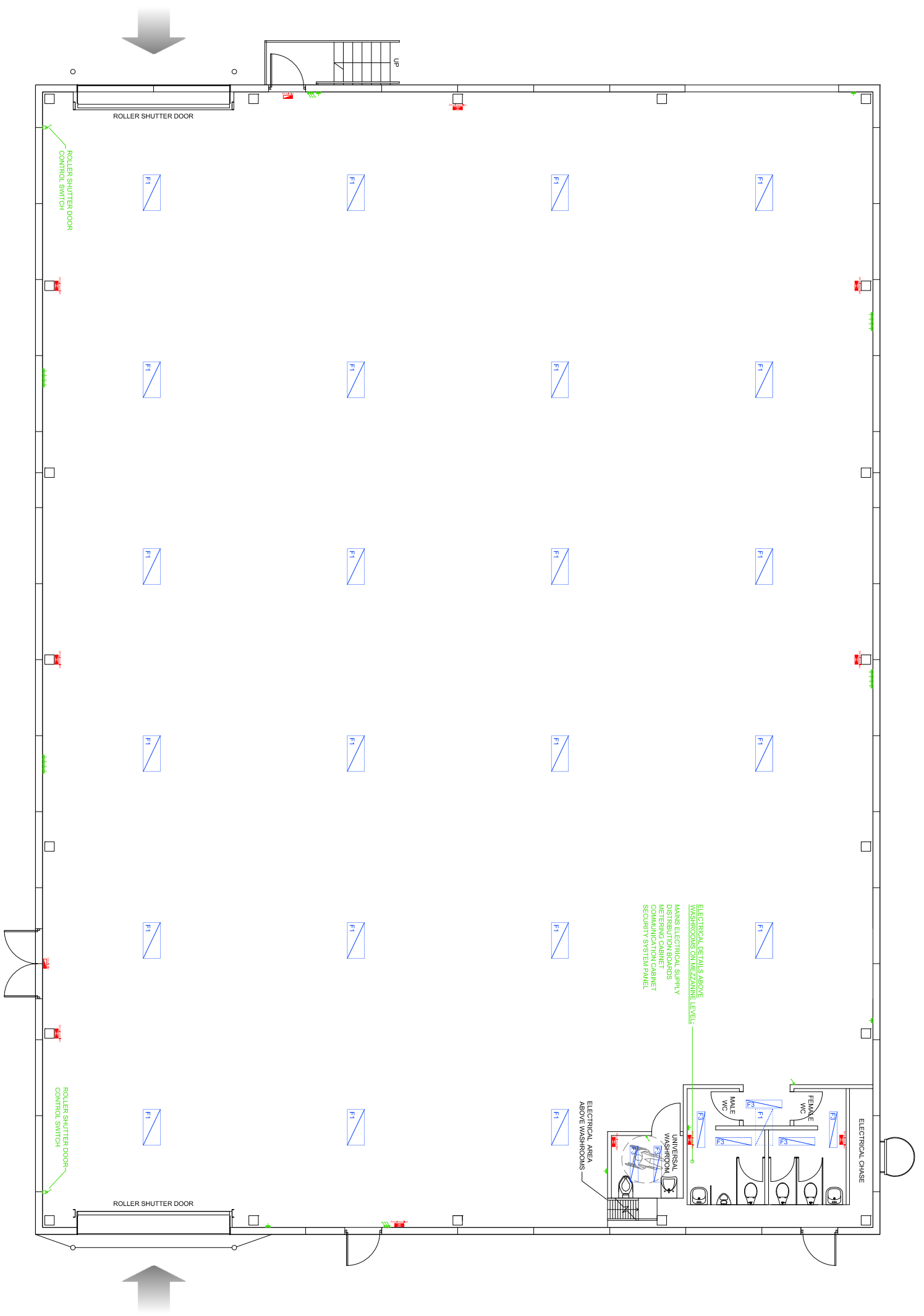

STAGE 10 DIMENSIONS	
STAGE LENGTH	= 118'-10" [36225mm]
STAGE WIDTH	= 87'-5" [26650mm]
USABLE FLOOR AREA	= 10,015 ft² [930m²]
GROSS AREA (INC. W.C.S)	= 10,396 ft² [965m²]

LEGEND:	
	ELECTRICAL
	EXISTING SINGLE GANG LIGHT SWITCH
	EXISTING DOUBLE GANG LIGHT SWITCH
	DSSO (DOUBLE POWER SOCKET OUTLET)
	240V CLEAN POWER SUPPLY SOCKET
	SINGLE SWITCHED SPRINKLER SOCKET
	DOUBLE DATA POINT OUTLET
	FIRE DETECTION
	EXISTING SMOKE DETECTOR
	EXISTING BREAK GLASS CALL POINT
	EXISTING FIRE ALARM BELL
	EXISTING AUDIBLE WARNING DEVICE
	EXISTING EMERGENCY BULBHEAD LIGHT
	EXISTING DIRECTIONAL LUMINAIRE
	EXISTING EMERGENCY EXIT LIGHT
	EXISTING DIRECTIONAL LUMINAIRE RUNNING MAN SIGNAGE
	EXISTING CO2 FIRE EXTINGUISHER
	EXISTING WATER FIRE EXTINGUISHER
	EXISTING FIRE HOSE REEL
	EXISTING EMERGENCY LIGHT TEST SWITCH
	EXISTING SMOKE DETECTOR ISOLATOR
	LIGHTING
	EXISTING WALL MOUNTED HOUSE LIGHT
	EXISTING CEILING MOUNTED HOUSE LIGHT
	EXISTING CIRCULAR BULBHEAD LIGHT WITH EMERGENCY PACK
	EXISTING CIRCULAR BULBHEAD LIGHT
	EXISTING CIRCULAR WALL MOUNTED LIGHT
	EXISTING CIRCULAR WALL MOUNTED LIGHT WITH EMERGENCY PACK
	EXISTING WALL MOUNTED LIGHT
	EXISTING HIGH BAY STAGE LIGHTING
	FLUORESCENT STRIP LIGHT (HOUSE LIGHT)
	CEILING MOUNTED FLUORESCENT STRIP LIGHT
	EXISTING HIGH BAY STAGE LIGHT ATTACHED TO GANTRY HANDRAIL
	GANTRY LEVEL
	MAIN STRUCTURAL BEAMS @ 30' ON CENTER
	RUNWAY BEAMS @ 100MM WIDE @ 0.000MM FROM FFL
	TRANSFER SYSTEM LOCATION
	GANTRY WALKWAY

THIS DRAWING IS THE PROPERTY OF PINEWOOD FILM PRODUCTION STUDIOS CANADA INC. AND MUST NOT BE COPIED OR REPRODUCED IN WHOLE OR IN PART, BY ANY MEANS, WITHOUT THE WRITTEN AUTHORIZATION OF PINEWOOD FILM PRODUCTION STUDIOS CANADA INC.

ALL DIMENSIONS TO BE CHECKED ON SITE PRIOR TO ANY COMMENCEMENT OF WORKS

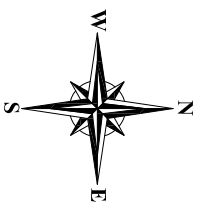

PROJECT MANAGEMENT DEPARTMENT

PROJECT
PINEWOOD TORONTO STUDIOS
CANADA

DRAWING TITLE
STAGE 10
EXISTING GROUND FLOOR PLAN

SCALE
1:150 @ A3

DATE
03-01-14

DRAWN BY
SDM



TORONTO STUDIOS