

THIS DRAWING IS THE PROPERTY OF PINEWOOD GROUP LTD AND MUST NOT BE COPIED OR REPRODUCED IN WHOLE OR IN PART, BY ANY METHOD WHATSOEVER, WITHOUT PERMISSION OR THE WRITTEN AUTHORISATION OF PINEWOOD GROUP LTD

ALL DIMENSIONS TO BE CHECKED ON SITE PRIOR TO ANY COMMENCEMENT OF WORKS



PINEWOOD STUDIOS SITE PLAN

LEGEND	
ELECTRICAL	
	EXISTING SINGLE GANG LIGHT SWITCH
	EXISTING DOUBLE GANG LIGHT SWITCH
	EXISTING DOUBLE POWER SOCKET (OUTLET)
	SINGLE SWITCHED POWER SOCKET
FIRE DETECTION	
	EXISTING SMOKE DETECTOR
	EXISTING BREAK GLASS CALL POINT
	EXISTING BREAK GLASS DOOR RELEASE
	EXISTING FIRE ALARM BELL
	EXISTING AUDIBLE WARNING DEVICE
	EXISTING EMERGENCY BALUSTRADE LIGHT
	EXISTING DIRECTIONAL ILLUMINATED EMERGENCY EXIT LIGHT
	EXISTING DIRECTIONAL LUMINOUS RUNNING WAY SIGNAGE
	EXISTING CO2 FIRE EXTINGUISHER
	EXISTING WATER FIRE EXTINGUISHER
	EXISTING FIRE HOSE REEL
	EXISTING EMERGENCY LIGHT TEST SWITCH
	EXISTING SMOKE DETECTOR ISOLATOR
LIGHTING	
	EXISTING WALL MOUNTED HOUSE LIGHT
	EXISTING CEILING MOUNTED HOUSE LIGHT
	EXISTING CIRCULAR BULKHEAD LIGHT WITH EMERGENCY TRACK
	EXISTING CIRCULAR BULKHEAD LIGHT
	EXISTING CIRCULAR WALL MOUNTED LIGHT WITH EMERGENCY TRACK
	EXISTING WALL MOUNTED LIGHT
	EXISTING HIGH BAY STAGE LIGHTING
	EXISTING HIGH BAY STAGE LIGHT ATTACHED TO GANTRY OVERHEAD
	EXISTING GANTRY HOUSE LIGHTING (REMOVABLE FLUORESCENT) STRIP LIGHT
GANTRY LEVEL	
	MAIN STRUCTURAL BEAMS
	APPROACH JAMBAY SIDE
	RUNWAY BEAMS
	TRANSFER SYSTEM LOCATION
	GANTRY RUNWAY

PROJECT MANAGEMENT DEPARTMENT

PROJECT
**PINEWOOD STUDIOS
THE RICHARD ATTENBOROUGH STAGE**

DRAWING TITLE
EXISTING GROUND FLOOR

SCALE	DATE	DRAWN BY
1:300 @ A3	01-10-13	SDM

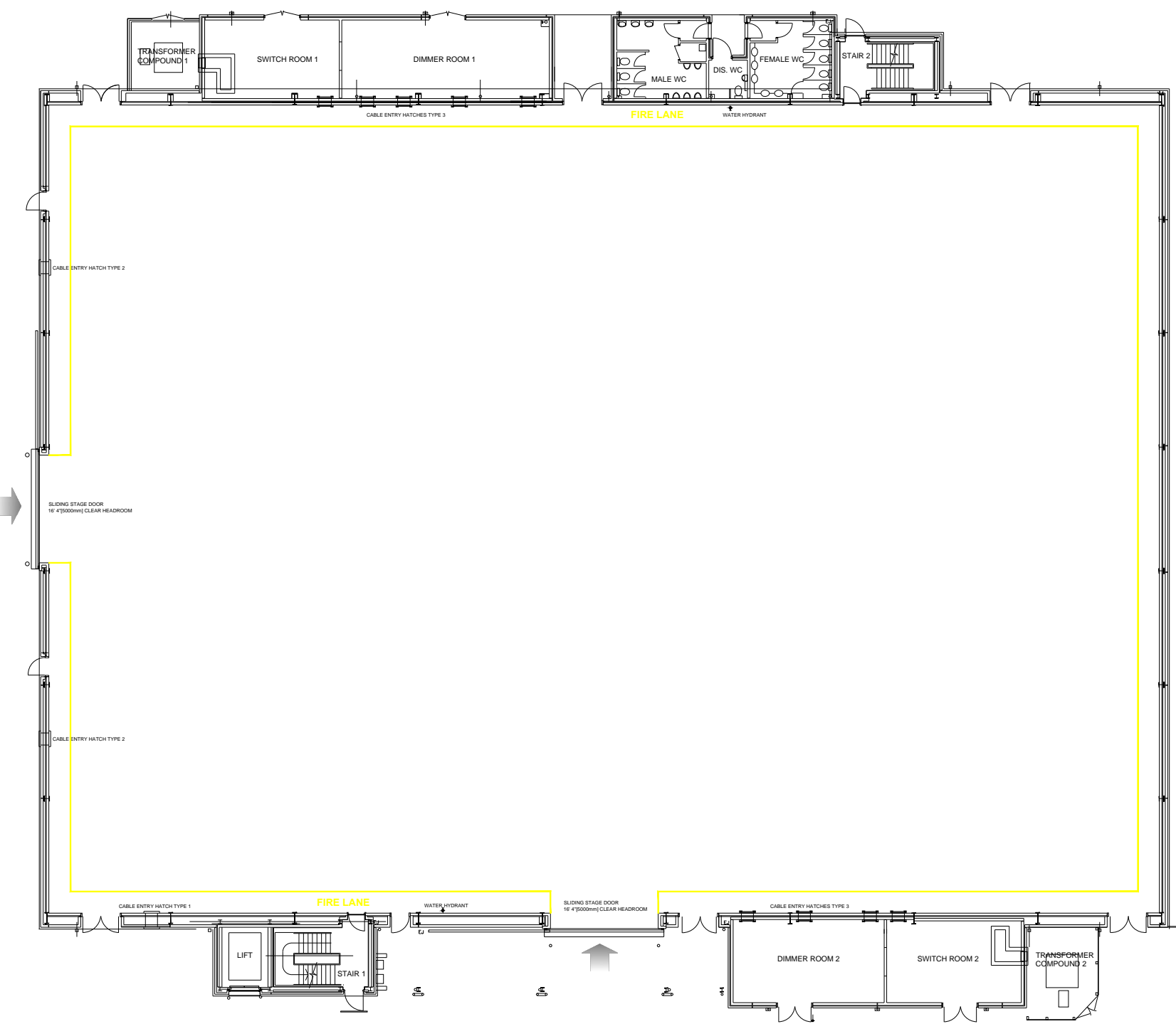

THE RICHARD ATTENBOROUGH STAGE | EXISTING GROUND FLOOR PINEWOOD STUDIOS



THE RICHARD ATTENBOROUGH STAGE DIMENSIONS	
STAGE LENGTH	= 203' 11" (61.9m)
STAGE WIDTH	= 147' 8" (45.0m)
GROUND FLOOR AREA	= 29,971 sq ft (27,760sqm)