



**R STAGE**  
**SPECIFICATION SHEET**

**DIMENSIONS**

	Feet	Metres
Length	85	36.58
Width	120	25.91
Height (To grid)	44	13.41
Stage Size	10,200	948sq.m

**TANK**

	Feet	Metres
Length	N/A	N/A
Width	N/A	N/A
Depth	N/A	N/A
	Gallons	Litres
Water Capacity	N/A	N/A
Filling Time	N/A	
Emptying Time	N/A	

**CHAINS, TACKLES BEAMS**

Runway Beams	10X4	25cmx10cm
Chains Tackles & Trolleys	26	
Weight Loading (Per tackle)	500kg (1102.30 lbs)	
Weight Loading (Runway Beams)	500kg 6' centres (1,102.30lbs 1.83m centres)	

**STAGE DOORS**

	No. Of		Dimensions
Large Stage Doors	X1	1)	16.8ftx19.6ft 5.12mx5.97m
pedestrian entrance doors	4		

**FIRE PROTECTION**

Stage covered by Beam Detection	✓
Red Fire Hydrant	x
Blue Fire Hydrant (Drinking water)	x
Sprinklers	x
fire Reels	✓

**FIRE EXTINGUISHERS**

	Floor	Gantry
Water	5	0
Co2	1	4
Foam	3	0

**FLOOR CONSTRUCTION**

Floor	timber ply boarding
-------	---------------------

**AIR LINES**

x

**AIR OUTLETS**

0

**ELECTRICAL SUPPLY**

Maximum Electrical Load	800 amps per phase
Additional Power Cable Access	x
Number of 13 Amp Sockets	4

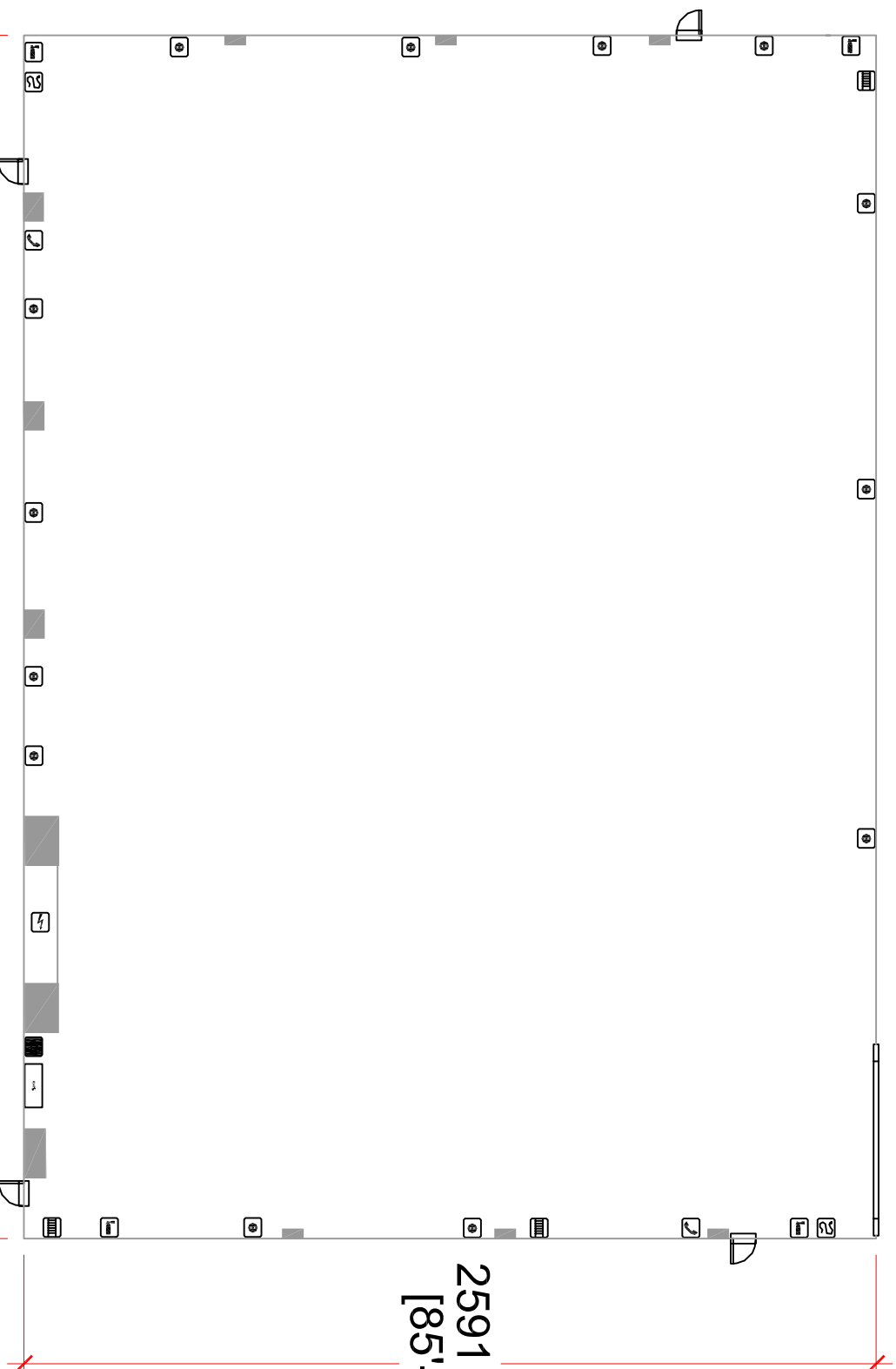

36580mm  
[120'-0" ]

25911mm  
[85'-0" ]



STUDIOS

<b>R STAGE</b>	Scale: 1:200 A3
L 120' x W 85' x H 45'	
L 36.6m x W 26m x H 13.4m	
Fire Extinguisher	
Electrical Supply Point	
Red Fire Hydrant	
Blue Fire Hydrant (Drinking Water)	
Mains Power	
Ladder	
Phone	
Electrical (Lights, Sound, Vents)	
Fire Hose	
Air Lines	